

Advance warning Paddock Wood Half Marathon road will be closed Sun 3 March 2024 9am to 3pm = **AWS**

TM Operative = **TM**

Total road closure = [Pink line]

Partial road closure (in direction of runners) = [Green line]

Local diversion route = [Dashed orange line]

Cone line = [Red line]

Eldon Way, Maidstone Road, Entrance and Exit of Warrington Road (all after start of race)

No parking cones = [Yellow line]

Ringden Ave and Maidstone Road

Position for return leg only = [Cyan box]

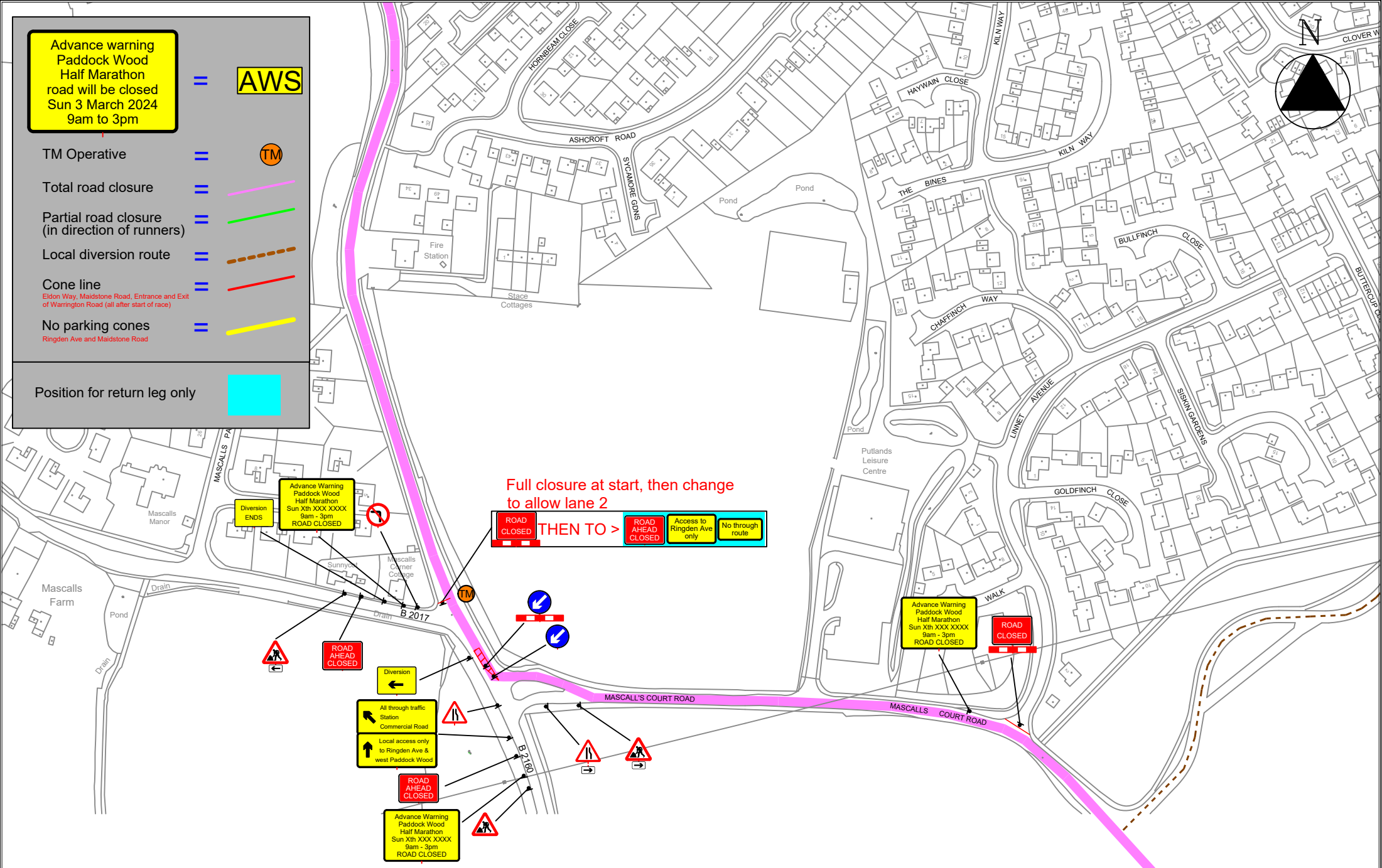

Full closure at start, then change to allow lane 2

ROAD CLOSED THEN TO > **ROAD AHEAD CLOSED** **Access to Ringden Ave only** **No through route**



ROAD AHEAD CLOSED

Diversion ←

All through traffic Station Commercial Road
Local access only to Ringden Ave & west Paddock Wood

ROAD AHEAD CLOSED

Advance Warning Paddock Wood Half Marathon Sun Xth XXX XXXX 9am - 3pm ROAD CLOSED

Advance Warning Paddock Wood Half Marathon Sun Xth XXX XXXX 9am - 3pm ROAD CLOSED

ROAD CLOSED



5 Roundmead Avenue
Loughton
Essex
IG10 1QA

Tel: 07804 167503
info@tigerhighways.com

Paddock Wood Athletic Club

1/2 Marathon
Traffic Management Plan
Page 4

Traffic Management Notes:
 1) All temporary traffic management shall be in accordance with Chapter 8 of the Traffic Signs Manual 2009, Traffic Signs Regulations and General Directions 2016 and the Safety at Street Works and Road Works, A Code of Practice, 2014;
 2) All temporary traffic management locations are indicative to aid clarity and are subject to approval from the on site engineer;
 3) All dimensions are in metres unless otherwise stated.
 4) All carriageway widths to be a minimum of 3.25m wide unless otherwise highlighted.
 5) This drawing has been specifically prepared to meet the requirements of the named client and may contain design or innovative features which differ from conventional design standards.
 6) Upon installation the TM Foreman is responsible for ensuring the design of the traffic management meets the on site requirements, Chapter 8 standards and any modifications as necessary.

Drawing No:
D-3113-4A-PADD-THQ2284

Scale: NTS

Original Size: A4

Date: 24/10/23