

**Advance warning Paddock Wood Half Marathon road will be closed Sun 3 March 2024 9am to 3pm** = **AWS**

**TM Operative** = **TM**

**Total road closure** =

**Partial road closure (in direction of runners)** =

**Local diversion route** =

**Cone line** =   
Eldon Way, Maidstone Road, Entrance and Exit of Warrington Road (all after start of race)

**No parking cones** =   
Ringden Ave and Maidstone Road

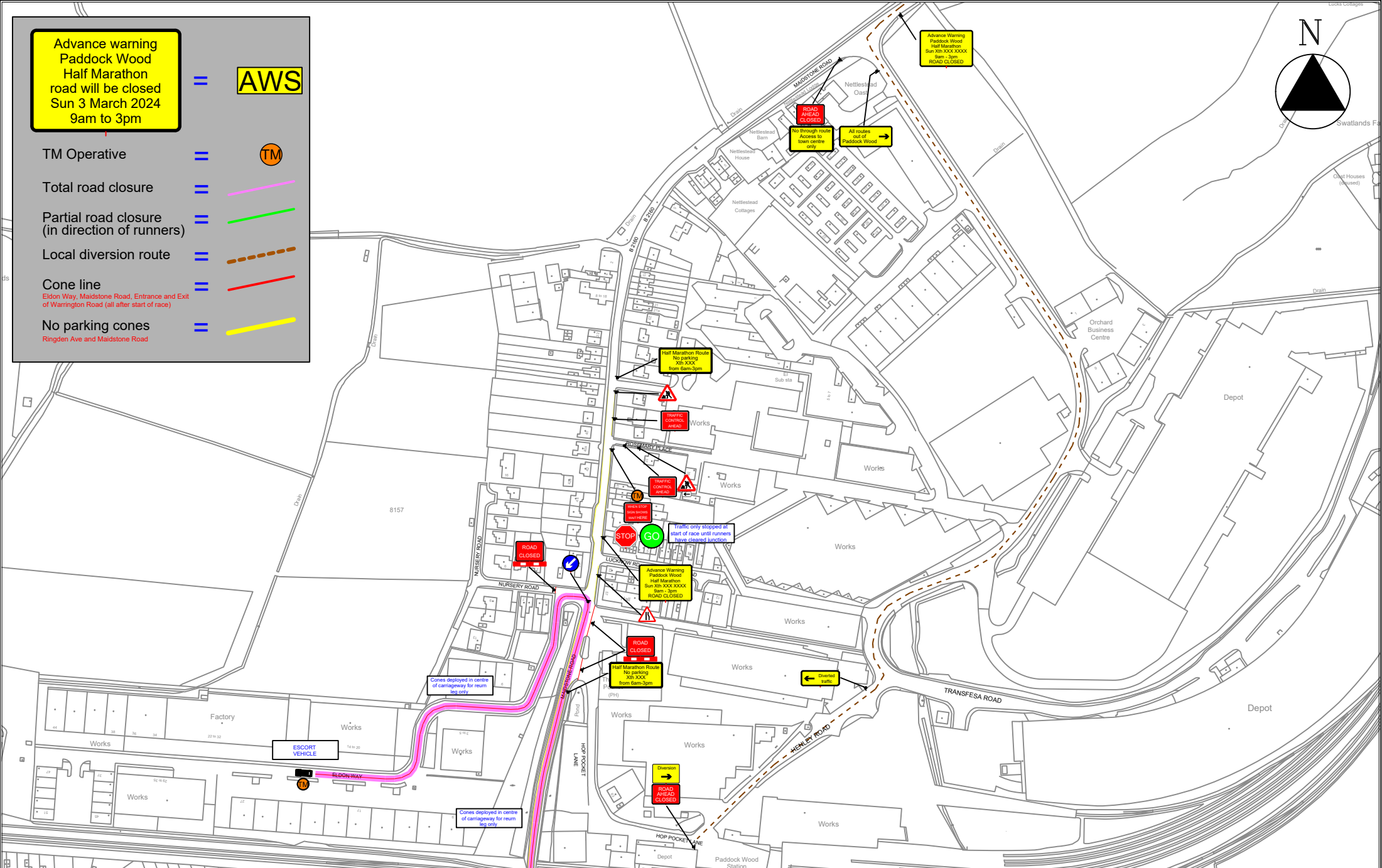
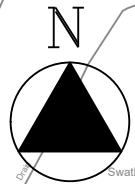

5 Roundmead Avenue  
Loughton  
Essex  
IG10 1QA  
  
Tel: 07804 167503  
  
info@tigerhighways.com

**Paddock Wood Athletic Club**  
  
1/2 Marathon  
Traffic Management Plan  
Page 1

**Traffic Management Notes:**  
 1) All temporary traffic management shall be in accordance with Chapter 8 of the Traffic Signs Manual 2009, Traffic Signs Regulations and General Directions 2016 and the Safety at Street Works and Road Works, A Code of Practice, 2014;  
 2) All temporary traffic management locations are indicative to aid clarity and are subject to approval from the on site engineer;  
 3) All dimensions are in metres unless otherwise stated.  
 4) All carriageway widths to be a minimum of 3.25m wide unless otherwise highlighted.  
 5) This drawing has been specifically prepared to meet the requirements of the named client and may contain design or innovative features which differ from conventional design standards.  
 6) Upon installation the TM Foreman is responsible for ensuring the design of the traffic management meets the on site requirements, Chapter 8 standards and any modifications as necessary.

**Drawing No:**  
D-3113-1A-PADD-THQ2284

**Scale:** NTS

**Original Size:** A4

**Date:** 24/10/23