

A

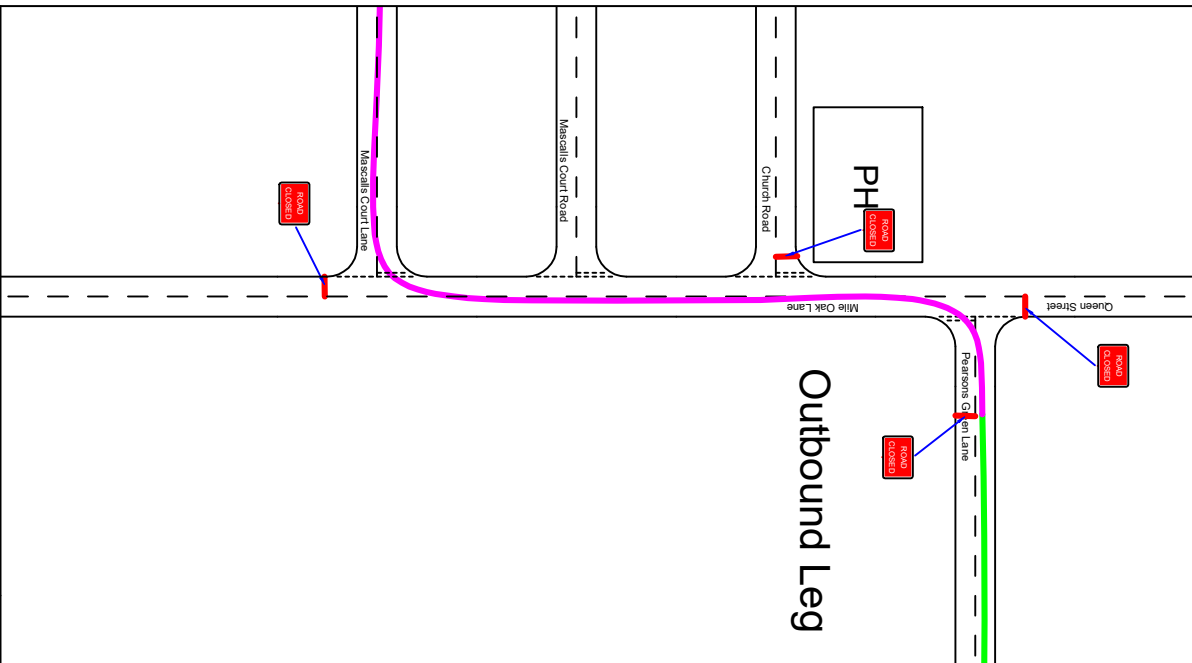

B

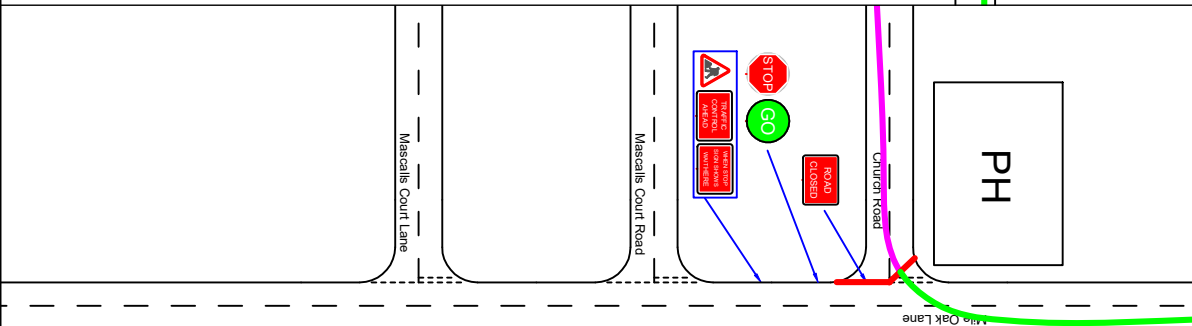

C

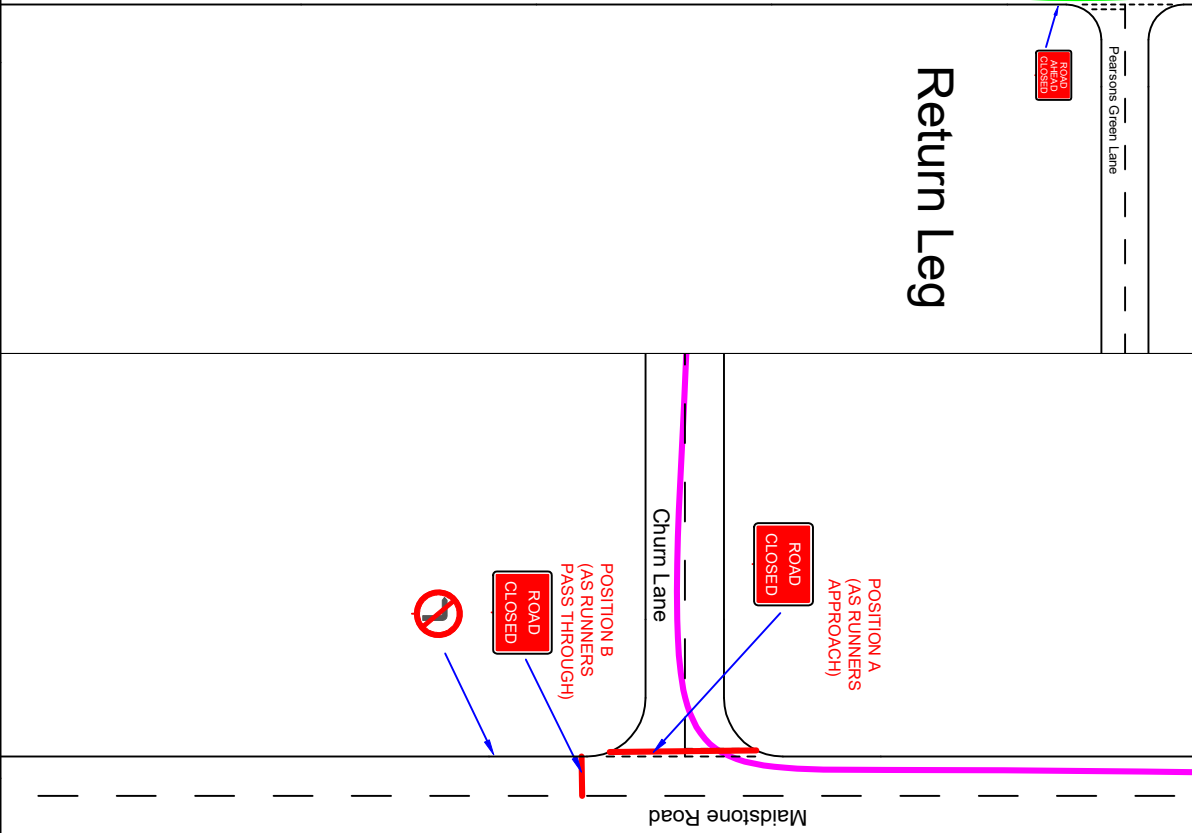

Outbound Leg

Return Leg



5 Roundmead Avenue  
 Loughdon  
 Essex  
 IG10 1QA  
 Tel: 07804 167503  
 info@tigerhighways.com

**Paddock Wood Athletic Club**

1/2 Marathon  
 Traffic Management Plan  
 Page 8

Traffic Management Notes:  
 1) All temporary traffic signs shall be in accordance with Chapter 8 of the Traffic Signs Manual 2009, Traffic Signs Regulations and General Directions 2016 and the Safety at Street Works and Road Works, A Code of Practice, 2014.  
 2) All temporary traffic management locations are indicative to aid clarity and are subject to approval from the on site engineer.  
 3) All dimensions are in metres unless otherwise stated.  
 4) All carriageway widths to a minimum of 3.2m wide unless otherwise highlighted.  
 5) All temporary traffic signs shall be in accordance with the Traffic Signs Manual 2009, Traffic Signs Regulations and General Directions 2016 and the Safety at Street Works and Road Works, A Code of Practice, 2014.  
 6) Upon installation the TM Foreman is responsible for ensuring the design of the traffic management meets the on site requirements, Chapter 8 standards and any modifications as necessary.

Drawing No.:

D-2083-8A-PADD-THQXXXX

Scale: NTS

Original Size: A4

Date: 21/01/20