







Advance Warning
Paddock Wood
Half Marathon
Sun 5th April 2020
0900hrs - 1500hrs
ROAD CLOSED

AWS

- TM Operative 
- Total road closure 
- Partial road closure (in direction of runners) 
- Local diversion route 
- Cone line 
- No parking cones 

Position for return leg only

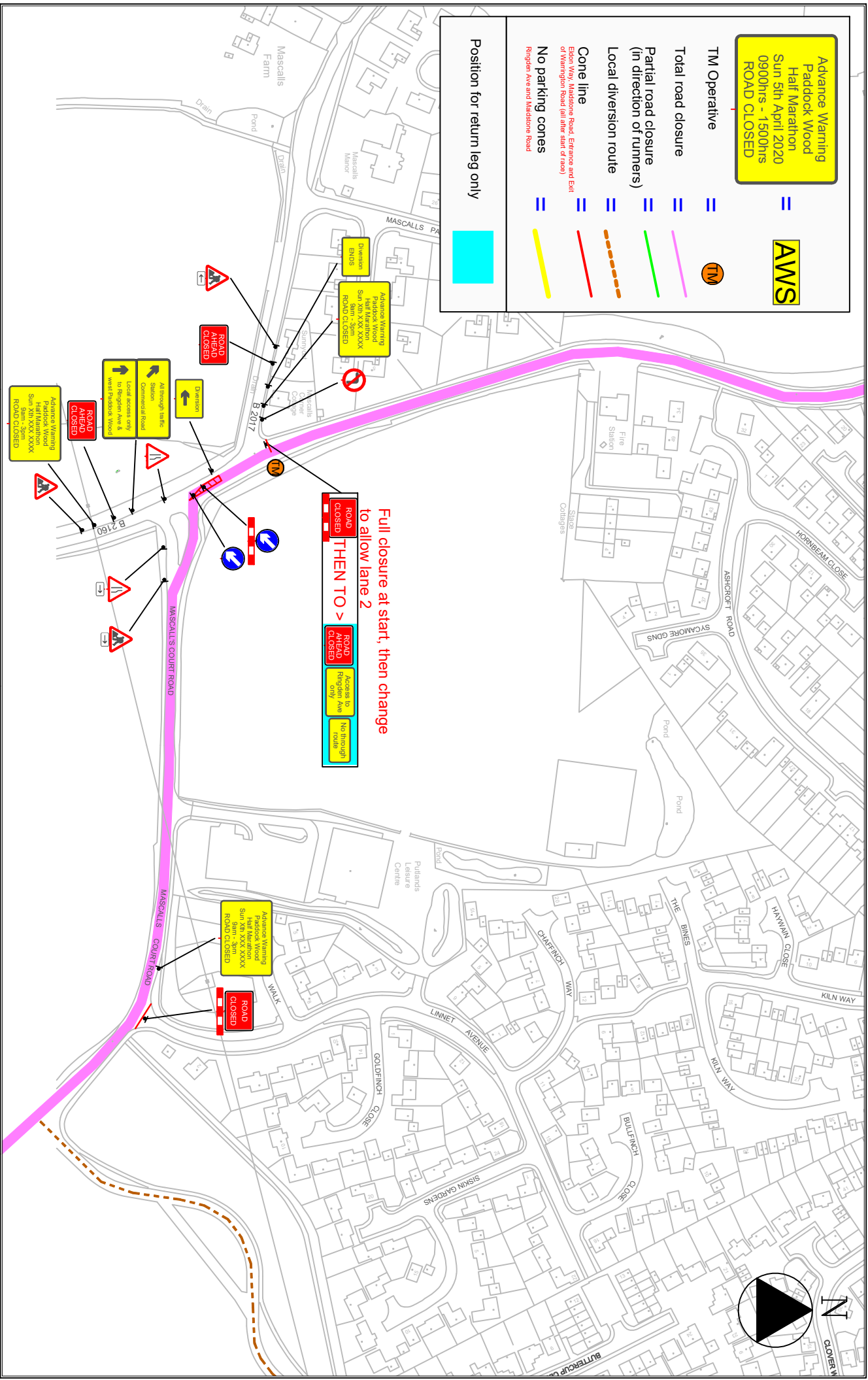

Full closure at start, then change to allow lane 2

ROAD CLOSED THEN TO > ROAD AHEAD ROAD CLOSED

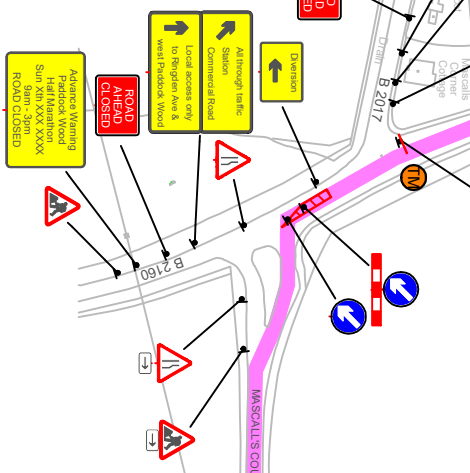

5 Roundmead Avenue
Loughborough
Essex
IG10 1QA
Tel: 07 804 167503
info@tigerhighways.com

Paddock Wood Athletic Club
1/2 Marathon
Traffic Management Plan
Page 4

Traffic Management Notes:

- 1) Road works and traffic management shall be in accordance with Chapter 8 of the Traffic Signs Manual 2009, Traffic Signs Regulations and General Directions 2016 and the Safety at Street Works and Road Works (A Code of Practice) 2014
- 2) All temporary traffic management locations are indicative to aid clarity and are subject to approval from the on site engineer.
- 3) All dimensions are in metres unless otherwise stated.
- 4) All carriageway widths to be a minimum of 3.25m wide unless otherwise highlighted.
- 5) This drawing has been specifically prepared to meet the requirements of the named client and may contain design or construction details that are not standard practice.
- 6) Upon installation the TM Foreman is responsible for ensuring the design of the traffic management meets the on site requirements. Chapter 8 standards and any modifications as necessary.

Drawing No: **D-2083-4A-PADD-THQXXXX**
Scale: NTS
Original Size: A4
Date: 02/12/21