









Advance Warning  
 Paddock Wood  
 Half Marathon  
 Sun 5th April 2020  
 09:00hrs - 15:00hrs  
**ROAD CLOSED**

**AMS**

- TM Operative 
- Total road closure 
- Partial road closure (in direction of runners) 
- Local diversion route 
- Cone line 
- East entry, Madstone Road, Entrance and Exit of Madstone Road (at inner side of road) 
- No parking cones 
- Ringsden Ave and Madstone Road 

Position for return leg only

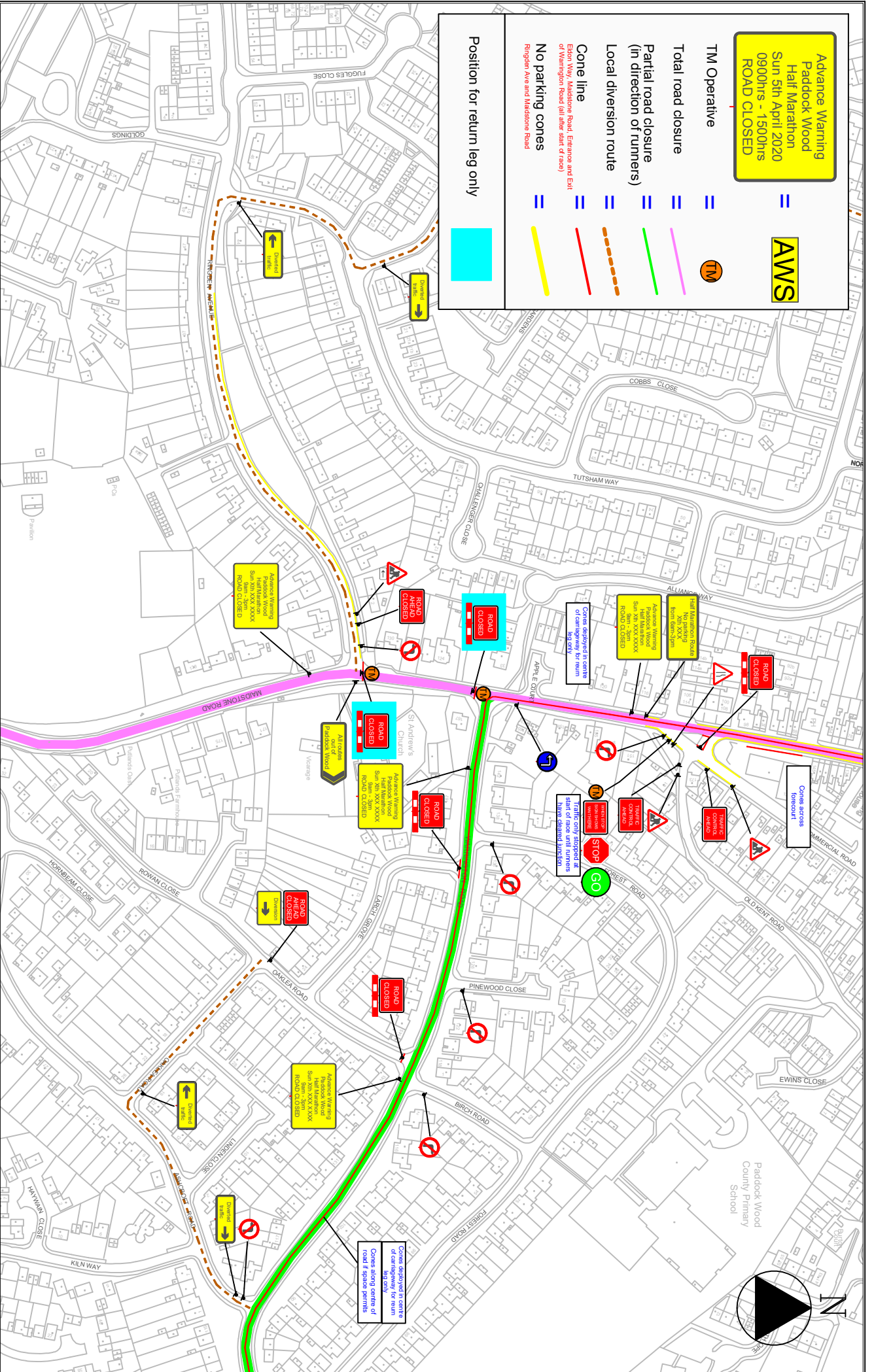

5 Roundmead Avenue  
 Loughton  
 Essex  
 IG10 1QA  
 Tel: 07804 167503  
 info@tigerhighways.com

**Paddock Wood Athletic Club**

1/2 Marathon  
 Traffic Management Plan  
 Page 3

**Traffic Management Notes:**

- 1) Traffic Management shall be in accordance with Chapter 8 of the Traffic Signs Manual 2009, Traffic Signs Regulations and General Directions 2016 and the Safety at Street Works and Road Works Code of Practice 2014.
- 2) All temporary traffic management locations are indicative to aid clarity and are subject to approval from the on site engineer.
- 3) All dimensions are in metres unless otherwise stated.
- 4) All carriageway widths to be a minimum of 3.25m wide unless otherwise highlighted.
- 5) This drawing has been specifically prepared to meet the requirements of the named client and may contain design or construction details that are not standard practice. The client is responsible for ensuring the design of the traffic management meets the on site requirements. Chapter 8 standards and any modifications as necessary.

Drawing No: **D-2083-3A-PADD-THQXXXX**

Scale: NTS

Original Size: A4  
 Date: 02/12/21