





Advance Warning  
Paddock Wood  
Half Marathon  
Sun 5th April 2020  
0900hrs - 1500hrs  
ROAD CLOSED

**AMS**

**TM Operative** = 

**Total road closure** = 

**Partial road closure (in direction of runners)** = 

**Local diversion route** = 

**Cone line** = 

**Exit route (to the right of the road)** = 

**Exit route (to the left of the road)** = 

**No parking cones** = 

**Ringier Ave and Maidstone Road** = 

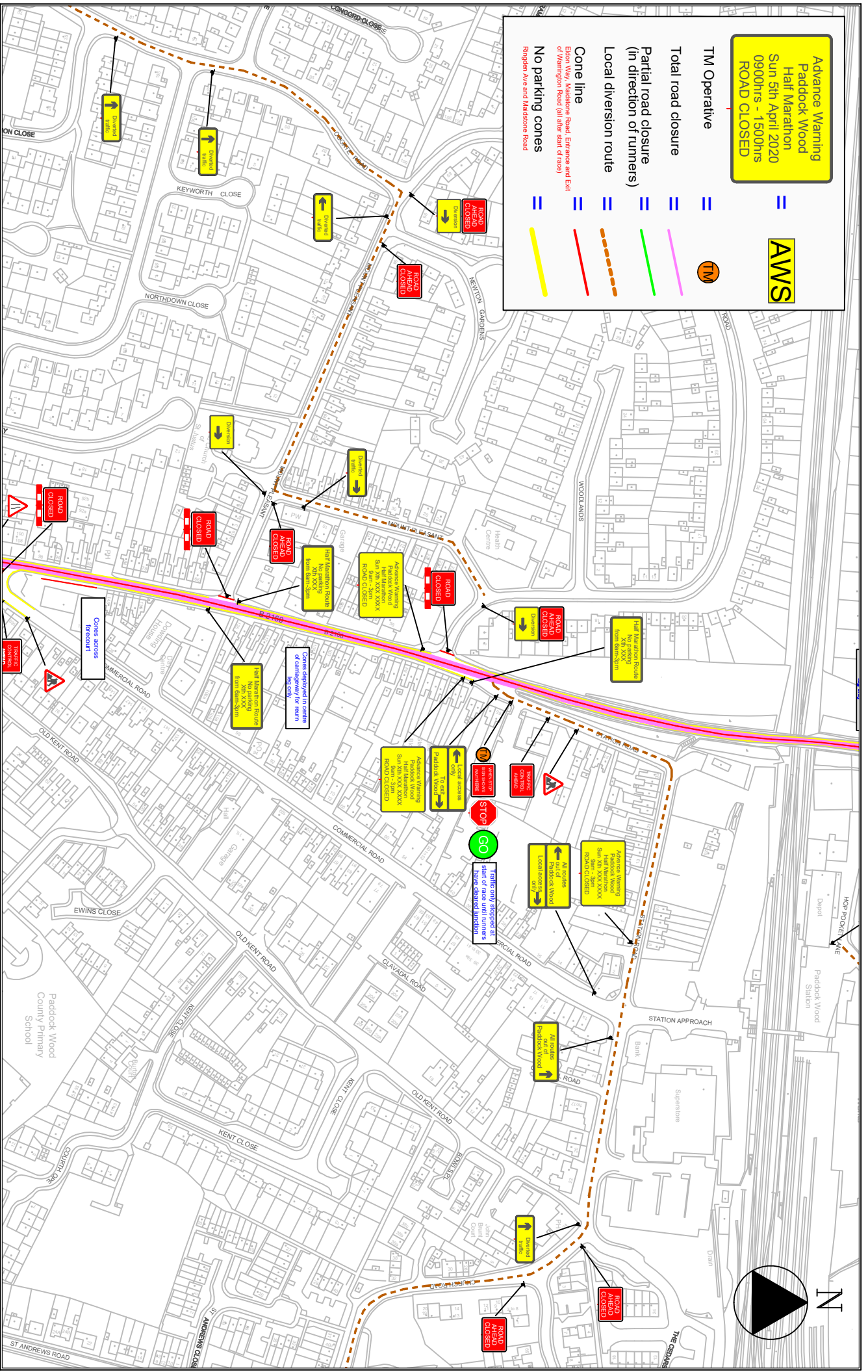

5 Roundmead Avenue  
Loughton  
Essex  
IG10 1QA  
Tel: 07 804 167503  
info@tigerhighways.com

**Paddock Wood Athletic Club**  
1/2 Marathon  
Traffic Management Plan  
Page 2

**Traffic Management Notes:**  
1) All signage and traffic management shall be in accordance with Chapter 8 of the Traffic Signs Manual 2009, Traffic Signs Roadworks and Road Management 2019 and the Safety at Street Works and Road Works Code of Practice 2014.  
2) All temporary traffic management locations are indicative to aid clarity and are subject to approval from the on site engineer.  
3) All dimensions are in metres unless otherwise stated.  
4) All carriageway widths to be a minimum of 3.25m wide unless otherwise highlighted.  
5) This drawing has been specifically prepared to meet the requirements of the named client and may contain design or other information that is confidential to the client. It is not to be used for any other purpose without the written consent of the TM Foreman who is responsible for ensuring the design of the traffic management meets the on site requirements. Chapter 8 standards and any modifications as necessary.

Drawing No: **D-2083-2A-PADD-THQXXXX**  
Scale: NTS  
Original Size: A4  
Date: 02/12/21