

Advance Warning  
 Paddock Wood  
 Half Marathon  
 Sun 5th April 2020  
 09:00hrs - 15:00hrs  
**ROAD CLOSED**

**AWS**

TM Operative



Total road closure



Partial road closure  
 (in direction of runners)



Local diversion route



Cone line



Essex Way, Millbrook Road, Eastgate and Exit  
 of M20 (A1 Road) (at other side of road)



No parking cones



Ringside Ave and Maidstone Road

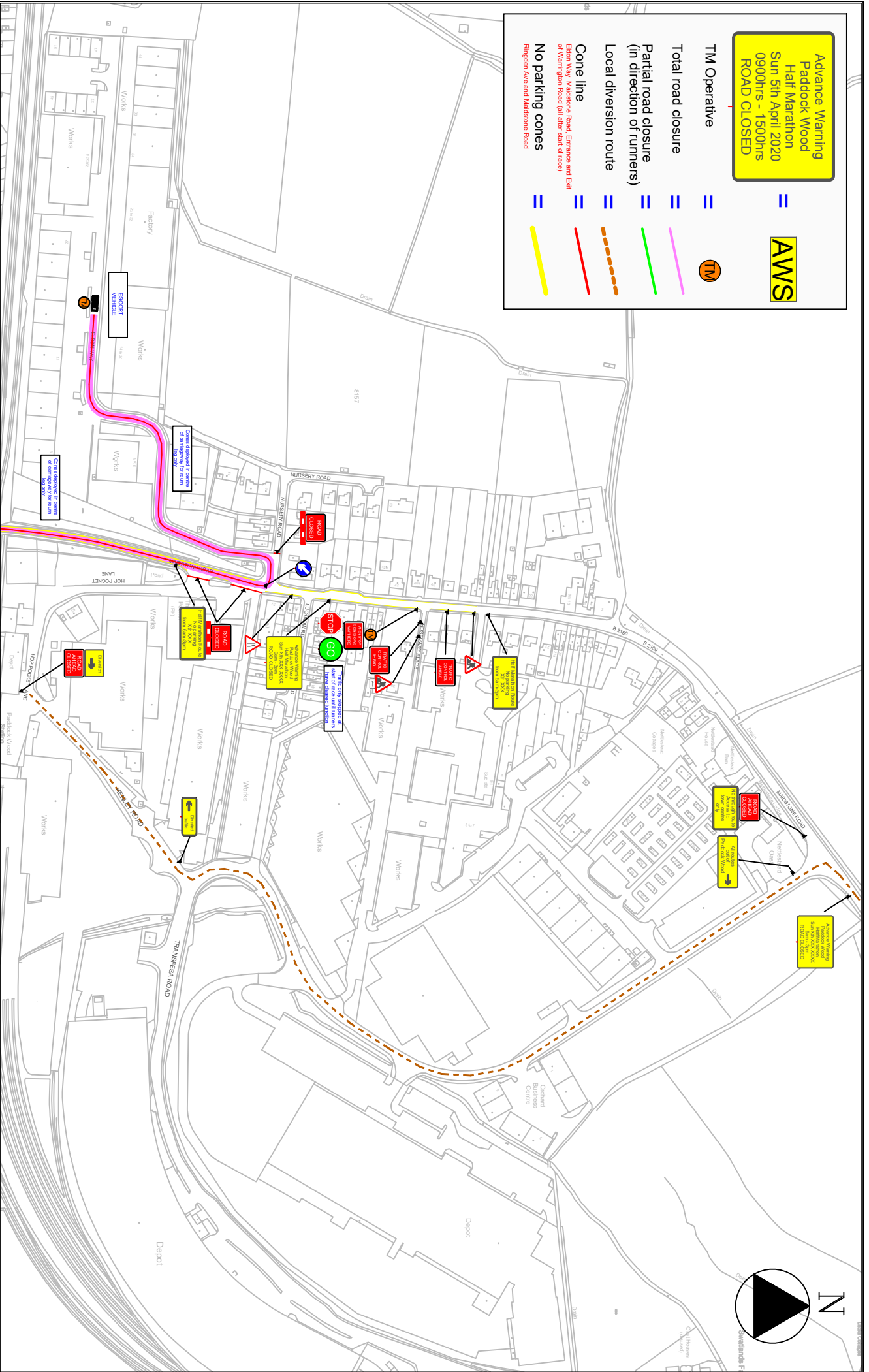

5 Roundmead Avenue  
 Loughdon  
 Essex  
 IG10 1QA  
 Tel: 07 804 167503  
 info@tigerhighways.com

**Paddock Wood Athletic Club**

1/2 Marathon  
 Traffic Management Plan  
 Page 1

**Traffic Management Notes:**

- 1) All signs and traffic management shall be in accordance with Chapter 8 of the Traffic Signs Manual 2009, Traffic Signs Regulations and General Directions 2016 and the Safety at Street Works and Road Works (A Code of Practice) 2014
- 2) All temporary traffic management locations are indicative to aid clarity and are subject to approval from the on site engineer
- 3) All dimensions are in metres unless otherwise stated
- 4) All carriageway widths to be a minimum of 3.25m wide unless otherwise highlighted
- 5) This drawing has been specifically prepared to meet the requirements of the named client and may contain design or construction details that are not standard practice
- 6) Upon installation the TM Foreman is responsible for ensuring the design of the traffic management meets the on site requirements. Chapter 8 standards and any modifications as necessary.

Drawing No.:

D-2083-1A-PADD-THQXXXX

Scale: NTS

Original Size: A4

Date: 02/12/21